

Potentiometer MTP

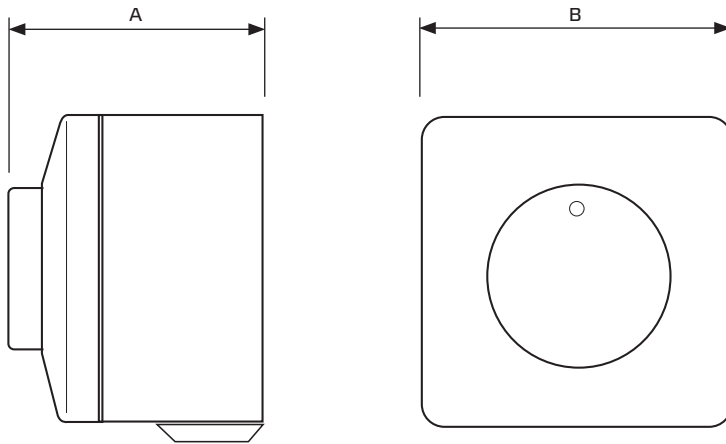

| Type | ID | A mm | B mm | C mm | D mm | Weight kg |
|--------|--------|---------|---------|---------|---------|--------------|
| MTP 50 | 153133 | 65 | 82 | 62 | 62 | 0,2 |

- Potentiometer with multifunctional output
- Surface and flush mounting
- Max. ambient temperature 40 °C
- Flush Mounting:
 - Protection class IP 44
- Surface mounting:
 - Protection class IP 54
- Supply voltage 230 VAC ±10% / 50-60 Hz
- Selectable output:
 - 1-10 VDC
 - 2-20 mA
 - 10-100 % PWM
- Minimum and maximum output value adjustable

Assembly :

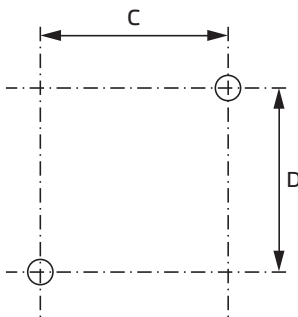

Wiring diagram :

